

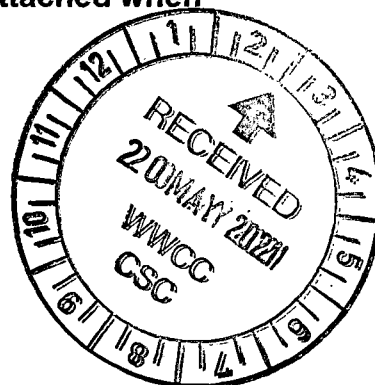

City of Wagga Wagga Planning Directorate

ADDITIONAL INFORMATION LODGEMENT FORM	
APPLIC NO:	DA21/0213
DESCRIPTION:	Plans
SITE ADDRESS:	12 macleay street
DESCRIPTION OF ADDITIONAL INFORMATION REQUESTED / SUBMITTED:	stormwater overflow & view from neighbouring property info.
Customer Services verification of above information:	
DEVELOPMENT OFFICER:	Robyn.
DATE INFO RECEIVED AT CUSTOMER SERVICES:	Rubee 20/05/21

NOTE: To expedite your submitted information, this Additional Information Lodgement Form is required to be attached when submitting your information.



Additional Information:

1. The storm water overflow from the water storage tank will be routed from the tank at the rear of the shed through 100mm plastic pipe to connect with the current storm water outlets from the rear of the house. (See diagram A)
2. The additional area requested for the shed is composed of weather awnings to protect the access points to the shed. The shed is orientated front to the East, and in aspect, is similar to the current shed that has deteriorated and contains asbestos sheeting. These additional awnings will not have an impact on neighbouring properties.

The view of the structure from the South, from No.10, is limited by structures (a 1.8m fence, a 4.0m brick stack, a 2.2m sound screen and the pergola/carport) built on No.10 Macleay St. (See Photo 1) and a screening slatted wall on the end of their rear deck. (See Photo 2)

The view of the structure from the West, 13 Edmondson St., is limited by structures (1.8m fence, a 2.2m sound screen and a 6.0m x 6.0 Shed) built on 13 Edmondson St. (See Photo 3 and 4)

The view of the structure from the South, No 14 Macleay, is screened by a Climbing Rose screen. (See Photo 5)

The view from the East is screened by a solid driveway gate and is not visible from the street.

E.J. Tomes
12 Macleay St
Turvey Park

Attached

Diagram A Storm Water Routing

Photo 1 View to the North to N0.10 showing Fence Line

Photo 2 View to the North to N0.10 showing Slat Screen

Photo 3 View to the West to Edmondson St.

Photo 4 View to the South-West to Edmondson St.

Photo 5 View to the South to 14 Macleay St.

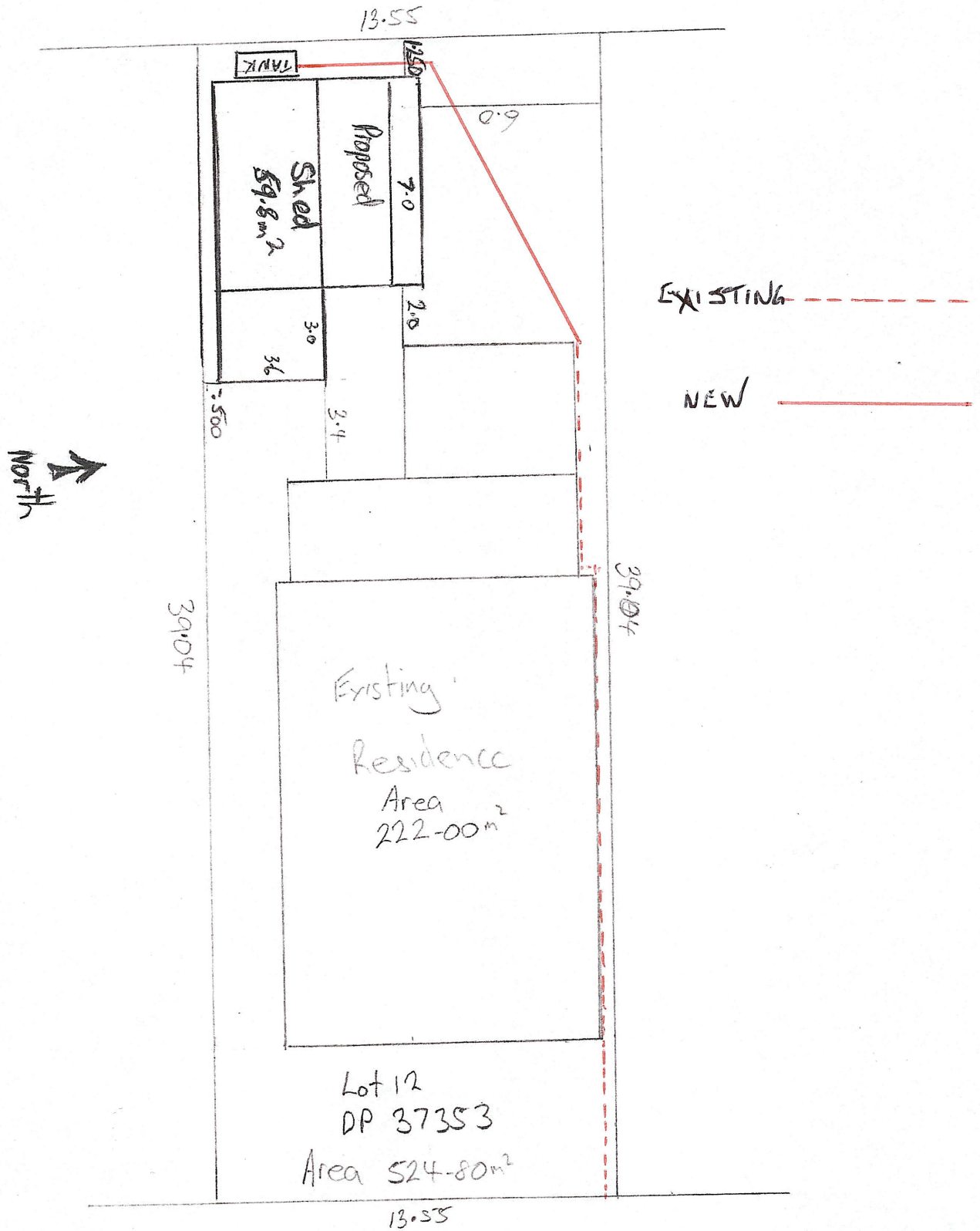

12 Macleay St
Wagga Wagga



Photo 1 View to the North to NO. 10 showing Fence Line

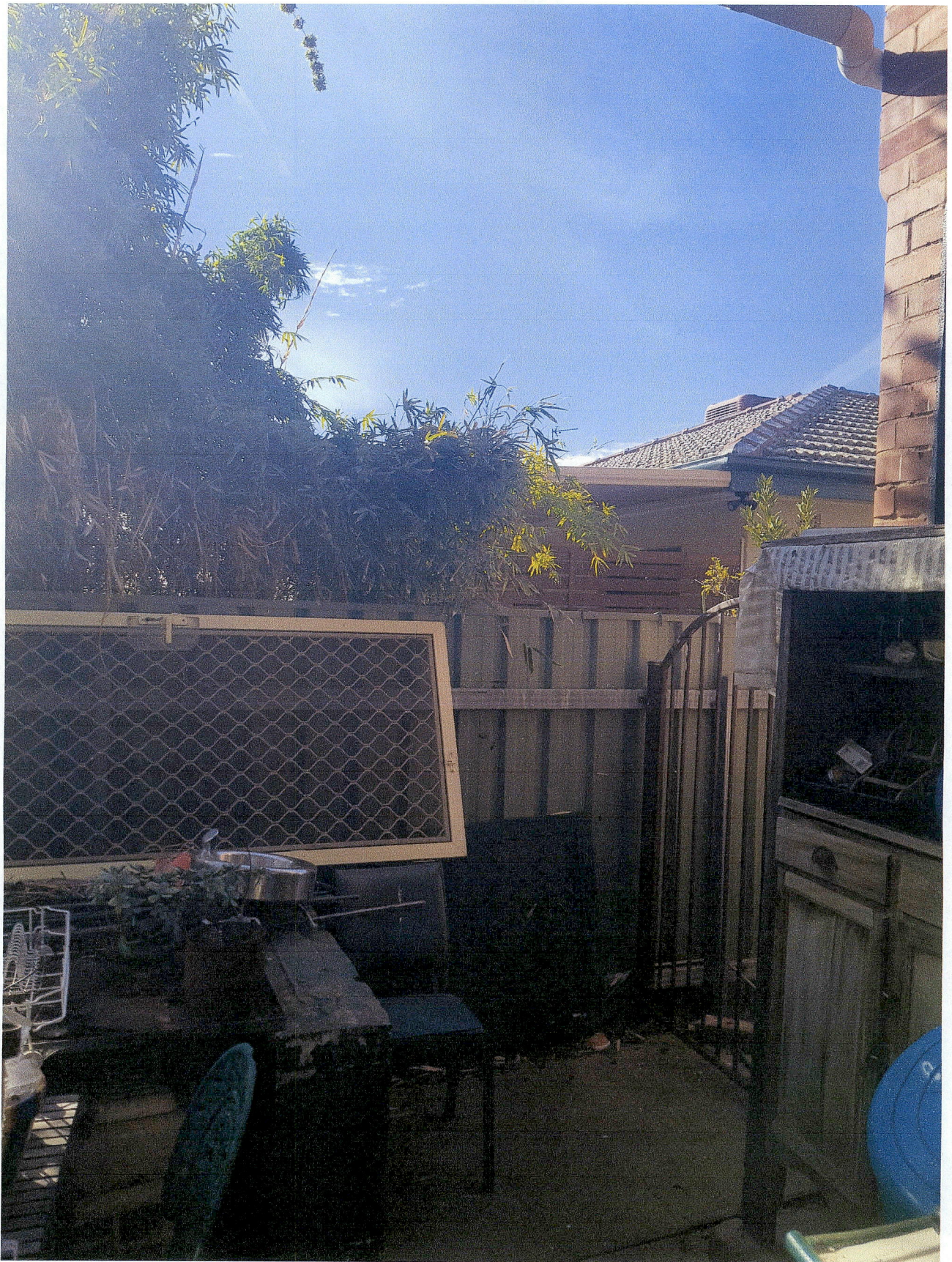

Photo 2 View to the North to N0.10 showing Slat Screen



Photo 3 View to the West to Edmondson St..



Photo 4 View to the South-West to Edmondson St..



Photo 5 View to the South to 14 Macleay St.