

52 PLUMPTON ROAD
LOT 336
DP 1247818

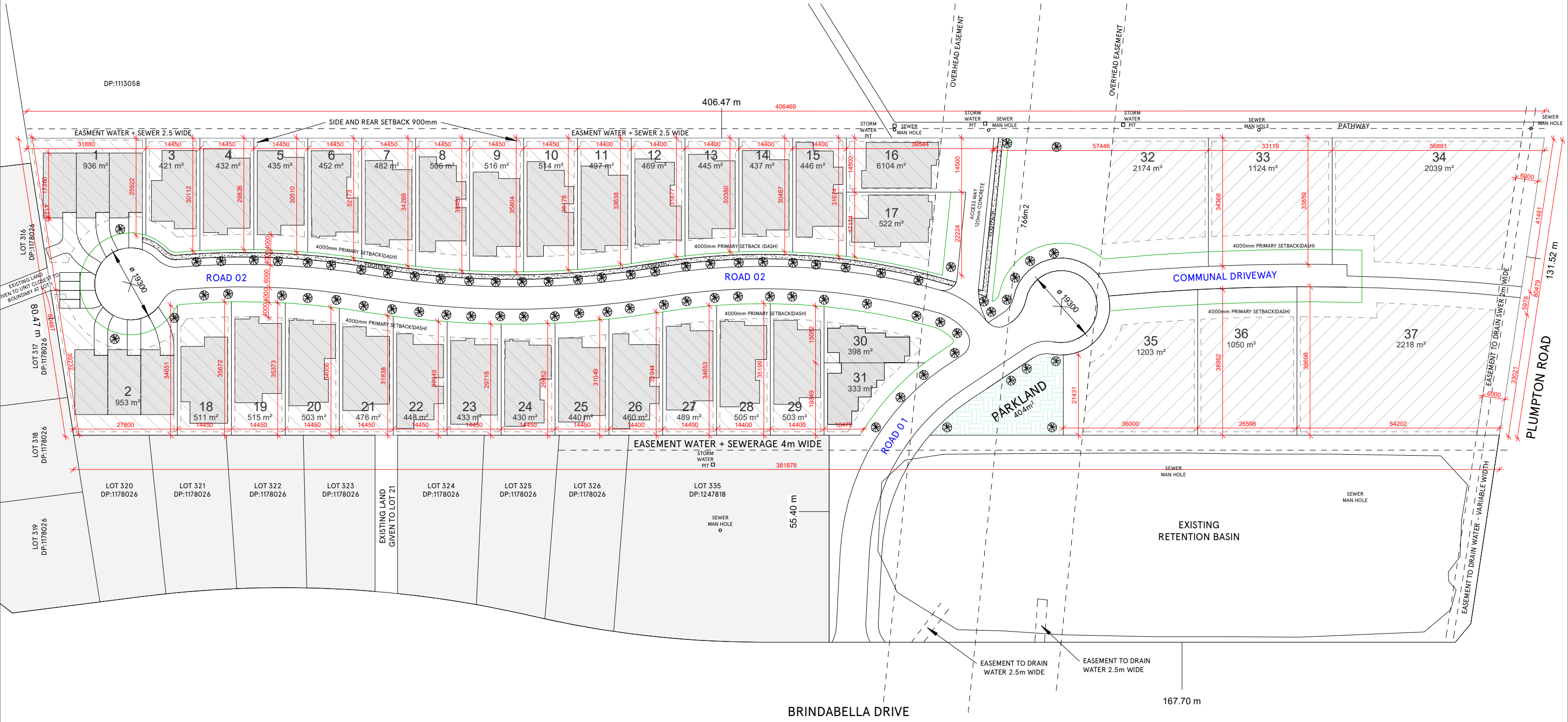

SITE PLAN

REV 13 - WWCC requests
13/07/2020
9:07:06 AM

A02

SITE PLAN

SITE LOCATION

52 PLUMPTON ROAD

CLIENT

MJH

PLUMPTON SUB-DIVISION

SCALE
1 : 1000

DO NOT SCALE OF THIS DRAWING. DISCREPANCIES ARE TO BE REFERRED TO THE BUILDER PRIOR TO COMMENCING WORK.
FINISH AND WORKMANSHIP TO COMPLY WITH THE BCA AND RELEVANT AUSTRALIAN STANDARDS. MATERIALS TO BE SUPPLIED NEW AND UNDAMAGED.
AS PER THE CONDITIONS OF THE CONTRACT, THESE DRAWINGS ARE A PRECISE REPRESENTATION OF WHAT IS TO BE BUILT AND ITEMS NOT ON THIS DRAWING OR IN THE SPECIFICATION ARE DEEMED NOT PART OF THE CONTRACT

CLIENT:
CLIENT:
BUILDER:



P. 02 6925 6888
info@mattjenkinshomes.com.au
po box 8757, Wagga Wagga, NSW 2650

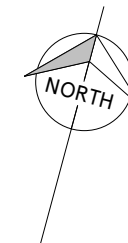

52 PLUMPTON ROAD
LOT 336
DP 1247818

* CONSTRUCTION OF NEW DWELLINGS ON UNCONTROLLED FILL
WILL BE PIERED INTO NATURAL AS PER ENGINEERS DESIGN

* ALL AREAS WILL BE REINSTATED WITH
EXCAVATED NATURAL MATERIAL AS REQUIRED

CURRENT TREES
TO BE REMOVED

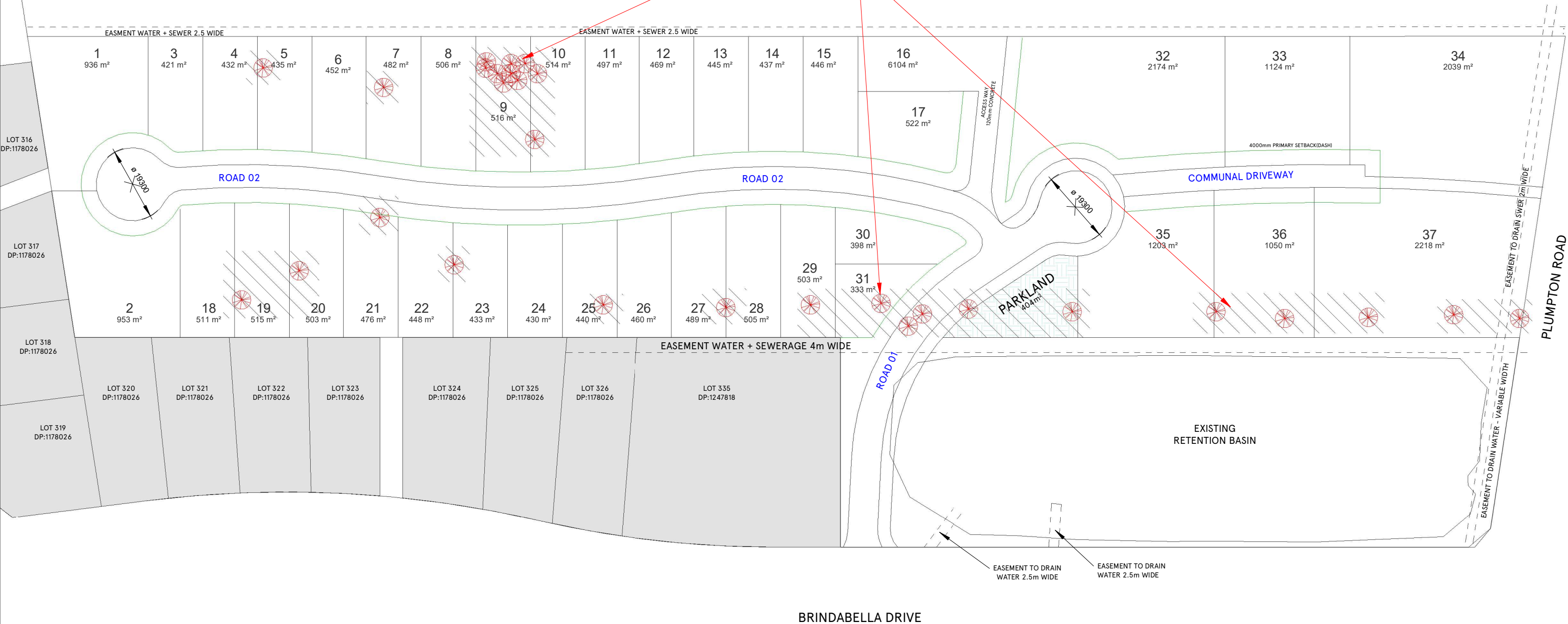

REV 13 - WWCC requests

13/07/2020
9:07:49 AM

A03

TREE REMOVAL

SITE LOCATION
52 PLUMPTON ROAD

CLIENT

MJH

PLUMPTON SUB-DIVISION

SCALE

1 : 1000

DO NOT SCALE OF THIS DRAWING. DISCREPANCIES ARE TO
BE REFERRED TO THE BUILDER PRIOR TO COMMENCING
WORK.
FINISH AND WORKMANSHIP TO COMPLY WITH THE BCA AND
RELEVANT AUSTRALIAN STANDARDS. MATERIALS TO BE
SUPPLIED NEW AND UNDAMAGED.
AS PER THE CONDITIONS OF THE CONTRACT, THESE
DRAWINGS ARE A PRECISE REPRESENTATION OF WHAT
IS TO BE BUILT AND ITEMS NOT ON THIS DRAWING OR
IN THE SPECIFICATION ARE DEEMED NOT PART OF THE
CONTRACT

CLIENT:

CLIENT:

BUILDER:

MJH

P. 02 6925 6888

info@mattjenkinshomes.com.au

po box 8757, Wagga Wagga, NSW 2650

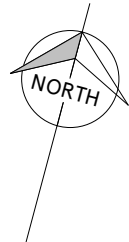

52 PLUMPTON ROAD
LOT 336
DP 1247818

* DEMOLITION OFF EXISTING PROPERTY WILL BE DONE BY EXCAVATOR WITH CONCRETE, TILES, BRICKS, AND RUBBLE TAKEN BY TRUCK TO LICENSED WASTE FACILITY. WOOD, PLASTERBOARD AND CABINETRY TO BE SEPERATED. POOL TO BE REMOVED AND PLACED WITH FILL.

- * CONSTRUCTION OF NEW DWELLINGS ON UNCONTROLLED FILL WILL BE PIERED INTO NATURAL AS PER ENGINEERS DESIGN
- * FILL ON CURRENT SITE WILL BE USED TO FILL:
- TREES AND TAP ROOTS HAVE BEEN REMOVED
 - POOL AREA
 - HOUSE AND SHEDS ONCE REMOVED

CURRENT BUILDINGS
- HOUSE AND SHEDS -
TO BE DEMOLISHED

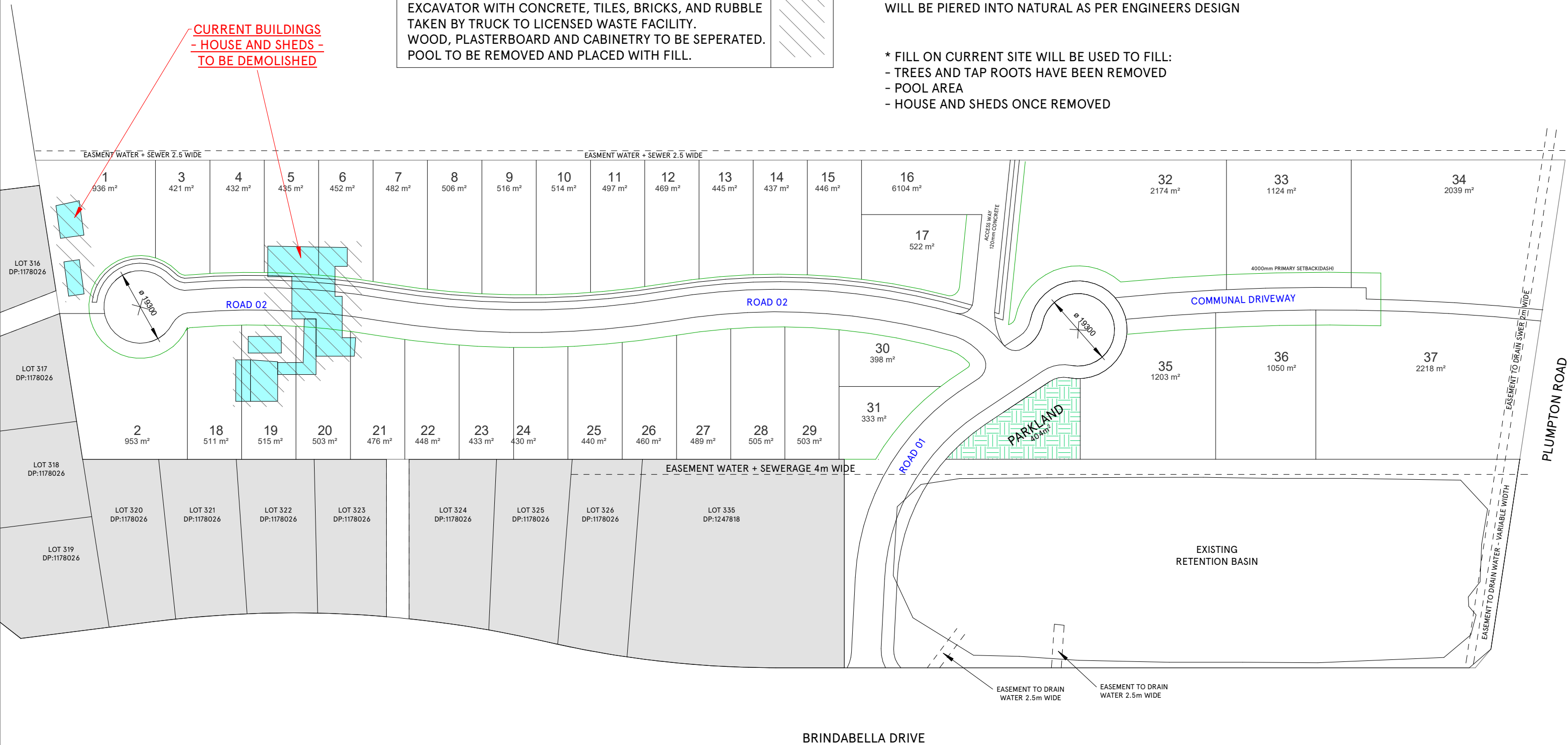

REV 13 - WWCC requests

13/07/2020
9:08:20 AM

A04

SITE - DEMOLITION

SITE LOCATION

52 PLUMPTON ROAD

CLIENT

MJH

PLUMPTON SUB-DIVISION

SCALE

1 : 1000

DO NOT SCALE OF THIS DRAWING. DISCREPANCIES ARE TO BE REFERRED TO THE BUILDER PRIOR TO COMMENCING WORK.
FINISH AND WORKMANSHIP TO COMPLY WITH THE BCA AND RELEVANT AUSTRALIAN STANDARDS. MATERIALS TO BE SUPPLIED NEW AND UNDAMAGED.
AS PER THE CONDITIONS OF THE CONTRACT, THESE DRAWINGS ARE A PRECISE REPRESENTATION OF WHAT IS TO BE BUILT AND ITEMS NOT ON THIS DRAWING OR IN THE SPECIFICATION ARE DEEMED NOT PART OF THE CONTRACT

CLIENT:

CLIENT:

BUILDER:

MJH

P. 02 6925 6888

info@mattjenkinshomes.com.au

po box 8757, Wagga Wagga, NSW 2650

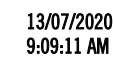
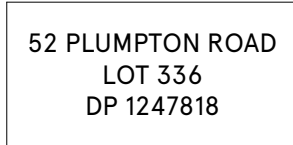

po box 8757, Wagga Wagga, NSW 2650

MARCH 9am



JUNE 9am



DEC 9am



MARCH 12pm



JUNE 12pm



DEC 12pm



MARCH 3pm



JUNE 3pm



DEC 3pm



REV 13 - WWCC requests 13/07/2020 9:09:39 AM

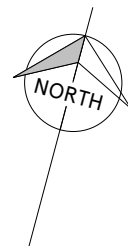

52 PLUMPTON ROAD
LOT 336
DP 1247818

LEGEND	
LOCAL TRAFFIC	-----
VISITOR PARKING	-----
ROAD CENTRE	-----

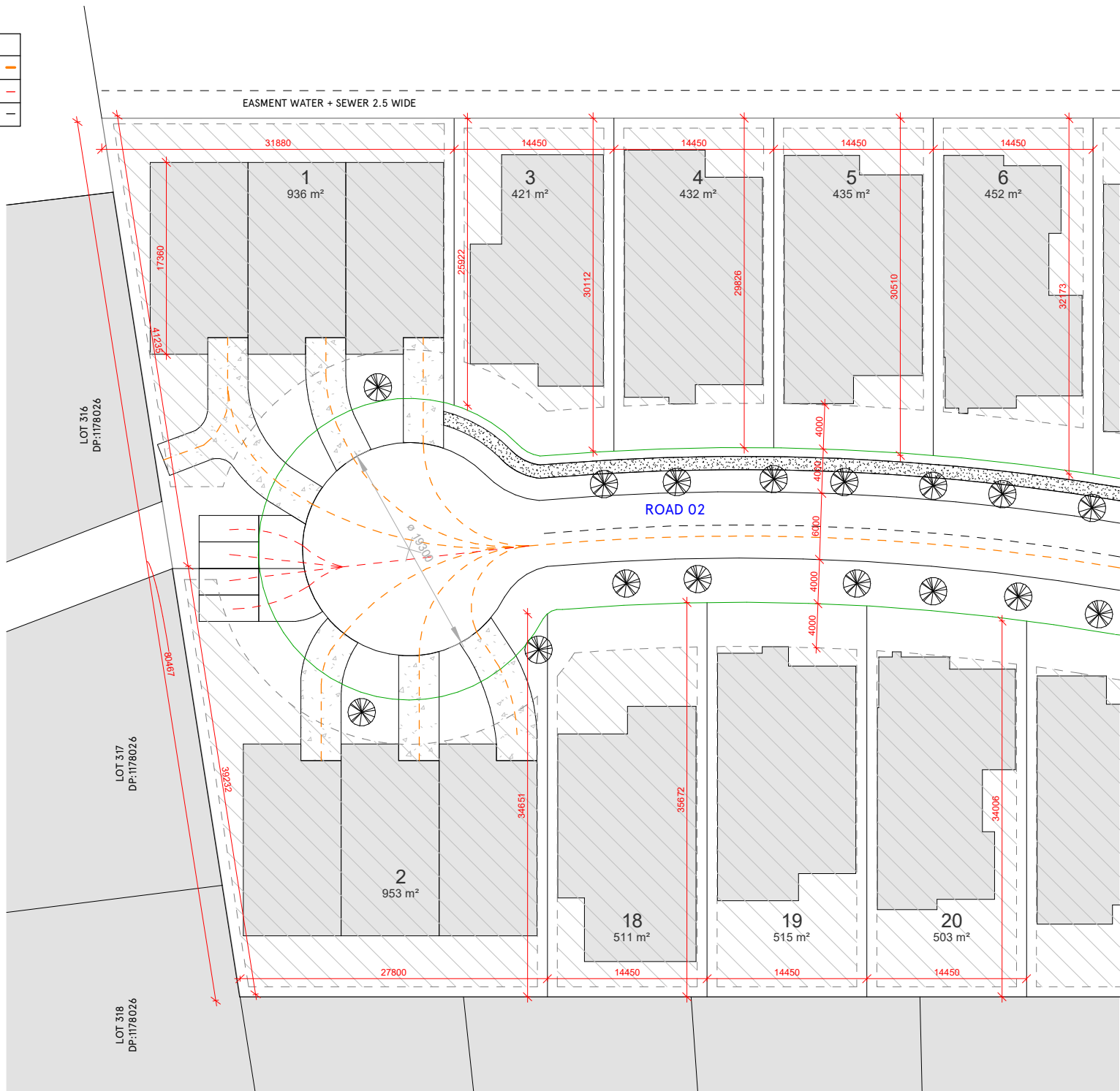

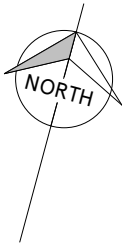

52 PLUMPTON ROAD
LOT 336
DP 1247818

DP:1113058



REV 13 - WWCC requests

15/07/2020
4:10:03 PM

A05.4
SITE - CUT AND FILL
SITE LOCATION
52 PLUMPTON ROAD

CLIENT
MJH
PLUMPTON SUB-DIVISION

SCALE
1 : 700

DO NOT SCALE OF THIS DRAWING. DISCREPANCIES ARE TO BE REFERRED TO THE BUILDER PRIOR TO COMMENCING WORK.
FINISH AND WORKMANSHIP TO COMPLY WITH THE BCA AND RELEVANT AUSTRALIAN STANDARDS. MATERIALS TO BE SUPPLIED NEW AND UNDAMAGED.
AS PER THE CONDITIONS OF THE CONTRACT, THESE DRAWINGS ARE A PRECISE REPRESENTATION OF WHAT IS TO BE BUILT AND ITEMS NOT ON THIS DRAWING OR IN THE SPECIFICATION ARE DEEMED NOT PART OF THE CONTRACT

CLIENT:
CLIENT:
BUILDER:



P. 02 6925 6888
info@mattjenkinshomes.com.au
po box 8757, Wagga Wagga, NSW 2650

SECTIONAL CUT FROM LOT 1 TO LOT 17
NORTHERN ROAD

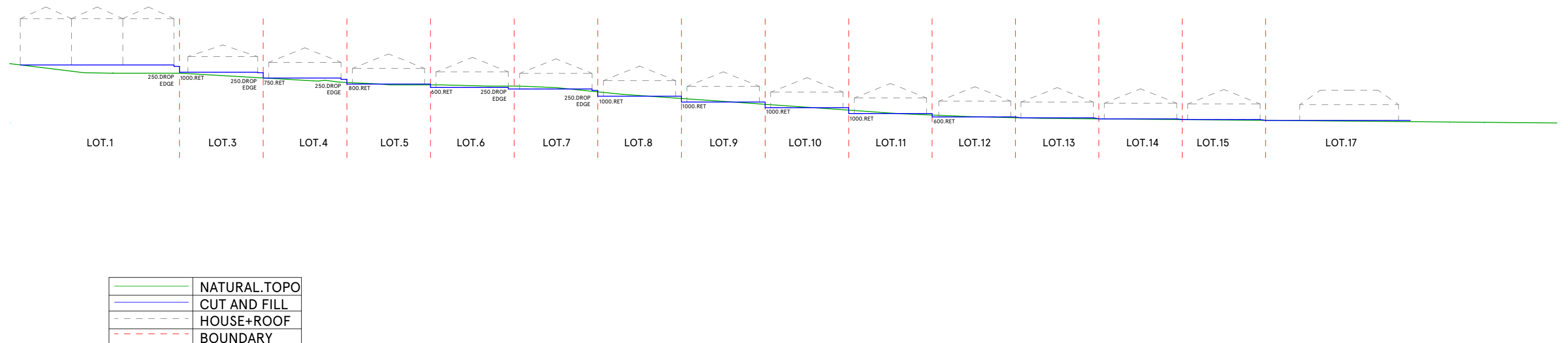

SECTIONAL CUT FROM LOT 2 TO LOT 30
SOUTHERN ROAD

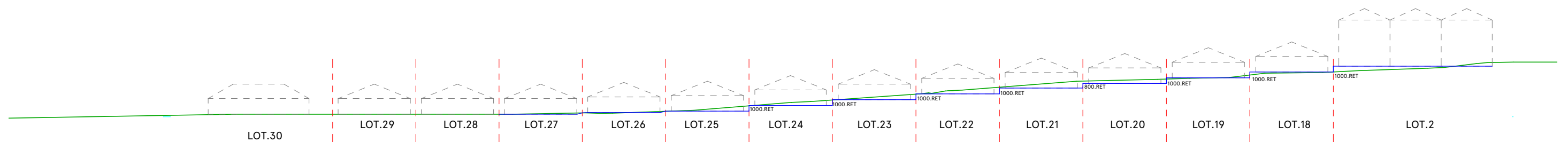

REV 13 - WWCC requests

5/07/2020
10:45 PM

A05.5 CUT+FILL SECTIONS

SITE LOCATION

52 PLUMPTON ROAD

CLIENT
MJH
PLUMPTON SUB-DIVISION

SCALE
As indicated

DO NOT SCALE OF THIS DRAWING. DISCREPANCIES ARE TO BE REFERRED TO THE BUILDER PRIOR TO COMMENCING WORK.

FINISH AND WORKMANSHIP TO COMPLY WITH THE BCA AND RELEVANT AUSTRALIAN STANDARDS. MATERIALS TO BE SUPPLIED NEW AND UNDAMAGED.

AS PER THE CONDITIONS OF THE CONTRACT, THESE DRAWINGS ARE A PRECISE REPRESENTATION OF WHAT IS TO BE BUILT AND ITEMS NOT ON THIS DRAWING OR IN THE SPECIFICATION ARE DEEMED NOT PART OF THE CONTRACT

CLIENT:

CLIENT:

BUILDER:

MJH

P. 02 6925 6888
info@mattjenkinshomes.com.au
po box 8757, Wagga Wagga, NSW 2650